

SC1500™ REV™

Stand-On Scrubber

Also Available in Disc



Advance

FACT SHEET



STAND-UP TO INCREASED PERFORMANCE AND PRODUCTIVITY

A COST-EFFICIENT CLEANING SOLUTION

Enhance your cleaning productivity with our stand-on automatic scrubber, the Advance SC1500™. Designed to deliver superior cleaning performance, the SC1500 stand-on scrubber provides a flexible, extremely maneuverable and compact solution for small to medium-sized areas. Plus, with a high-capacity tank, the SC1500 can cover more surface faster while maximizing your bottom line.

MAXIMUM PRODUCTIVITY

To satisfy both daily and deep scrubbing applications, the SC1500 is available in a 20 inch disc or 20 inch REV™ model. The SC1500 REV employs our patent pending Dual Random Orbital Scrubbing technology, which scrubs deeper and more uniformly to leave a perfectly scrubbed surface with no swirl marks while using far less water and chemicals. Spend more time on the floor with the SC1500's large 12 gallon solution tank and low flow rate, which can provide up to 109 minutes of scrub time without refilling. Increased down pressure at 88 pounds enables one pass cleaning for efficient cleaning results.

CONSISTENT, EASY CLEANING

The SC1500 ensures consistent, reliable cleaning with solution flow rate control right at your fingertips. Select from low, medium or high to match the job at hand without stopping the machine. This not only minimizes chemical and water waste but also reduces time spent on dump and refills. For simple operation, all scrubbing parameters—detergent strength, brush pressure, solution flow and vacuum—are all controlled with a single button and are clearly displayed on the easy-to-read, LCD graphical display.

GREEN MEETS CLEAN

Clean green and still meet the highest expectations for clean floors with the standard onboard EcoFlex System™. The EcoFlex System controls the consumption of detergent so effectively that real savings can be gained without compromising performance. With a single button, effortlessly switch between chemical-free cleaning or select from weak to strong cleaning intensities to match cleaning performance to the soil on the floor and the required level of clean. More soil? No problem. Activate the "burst of power" for extra cleaning performance and easily return to the original settings for minimum usage of water, detergent and power.

STANDARD FEATURES INCLUDE

- Dual Random Orbital Scrubbing technology or traditional disc
- Extremely maneuverable and compact
- Productivity of a rider scrubber and cost-efficiency of a walk-behind scrubber
- Onboard EcoFlex™ System standard
- 20 inch (51 cm) scrub path, pad holders included
- 12 gallon (45 L) solution tank
- 12.5 gallon (47 L) recovery tank
- Two scrub pressures up to 88 lb (40 kg)
- Quiet mode for daytime cleaning
- Debris catch cage standard
- Onboard charger standard

TYPICAL APPLICATIONS INCLUDE

- Schools and Universities
- Hospitals/Healthcare Facilities
- Grocery
- Retail Outlets
- Sport Centers
- Office Buildings
- Entertainment Arenas

ecoflex™ system



Advance SC1500™ REV™

Stand-On Scrubber

Also Available in Disc



REV™ model only – Patent-pending REV™ random orbital scrubbing technology with high-speed, ¼-inch micro scrubbing and rotational, low-speed macro scrubbing attacks dirt from multiple directions for superior cleaning effectiveness.



Flip-up lid and tilt-back tank provides easy access to the recovery tank, debris catch cage, batteries and EcoFlex™ cartridge.

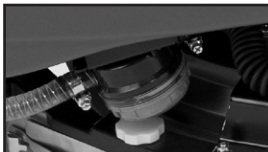

Externally mounted solution filter allows operators to easily clean the filter and manage the solution level.



Squeegee wraps around the deck for 100% water pick-up and simply clips onto the bracket with no thumb nuts or adjustment required.

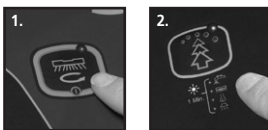

1. Scrubbing parameters are easily controlled with a single button.
2. EcoFlex™ System Burst of Power button easily increases cleaning performance.



- Large recovery tank opening, complete draining and smooth interior for easy cleaning
- Front fill port allows easy, flexible tank filling
- Front polyurethane tire for outstanding traction and high durability
- Wrap-around squeegee ensures 100% water pick-up and dry floors
- Safety dead-man switch and GO pedal provides easy-to-control operation
- Quiet mode for daytime cleaning and cleaning of noise-sensitive areas
- EcoFlex™ onboard detergent system provides flexible cleaning performance
- Rear fill port allows easy, flexible tank filling
- Low foot platform height for easy on/off
- Rear polyurethane tires for outstanding traction and high durability

Defining Cleaning Innovation...

- Our products are designed using innovative technology that increases productivity and drives down the cost to clean.
- You can get expert service and maintenance for your Advance machines from factory-trained personnel around the world. Fast parts delivery, too.
- Maintain peak performance with Nilfisk Genuine OEM Parts.

Nilfisk Genuine OEM Parts

Technical Specifications

Models	SC1500™ R	SC1500™ D
Scrub Head	REV™	Disc
Scrub Path	20 in (51 cm)	20 in (51 cm)
Solution Tank	12 gal (45 L)	12 gal (45 L)
Recovery Tank	12.5 gal (47 L)	12.5 gal (47 L)
Machine Voltage	24 V	24 V
Vacuum Motor	0.66 hp (492 W) 3-stage	0.66 hp (492 W) 3-stage
Scrub Motor	0.75 hp (559 W)	0.51 hp (380 W)
Scrub Motor RPM	2,250	140
Low Scrub Pressure Max	64 lb (29 kg)	51 lb (23 kg)
High Scrub Pressure Max	88 lb (40 kg)	88 lb (40 kg)
Drive Motor	0.375 hp (280 W)	0.375 hp (280 W)
Max Transport Speed	3 mph (4.8 kph)	3 mph (4.8 kph)
Max Scrub Speed	2.6 mph (4.2 kph)	2.6 mph (4.2 kph)
Max Coverage	26,400 ft ² (2,453 m ²)	26,400 ft ² (2,453 m ²)
Max Sound Pressure Level (IEC 60704-1)	63 dB A / .029344 µPa	63 dB A / .029344 µPa
Low Flow Rate	0.11 gal/min (0.4 L/min) or 109 minutes per solution tank	0.16 gal/min (0.6 L/min) or 75 minutes per solution tank
Medium Flow Rate	0.16 gal/min (0.6 L/min) or 75 minutes per solution tank	0.35 gal/min (1.3 L/min) or 34 minutes per solution tank
High Flow Rate	0.23 gal/min (0.9 L/min) or 52 minutes per solution tank	0.5 gal/min (1.9 L/min) or 24 minutes per solution tank
Minimum Aisle Turn Width	59.5 in (151 cm)	59.5 in (151 cm)
Squeegee Width	26.5 in (67.3 cm)	26.5 in (67.3 cm)
Length	48.5 in (123.2 cm)	48.5 in (123.2 cm)
Width	24 in (61 cm)	24 in (61 cm)
Height	52.5 in (133.4 cm)	52.5 in (133.4 cm)
Gross Weight	719 lb (326 kg)	718 lb (326 kg)
<small>(standard machine w/o options; w/full solution tank, empty recovery tank and heaviest batteries installed) – without rider</small>		
Part Number	56104012 – with EcoFlex, 208 Ah wet batteries 56104013 – with EcoFlex, 140 Ah maint-free (AGM) batteries	56104010 – with EcoFlex, 208 Ah wet batteries 56104011 – with EcoFlex, 140 Ah maint-free (AGM) batteries

Specifications are subject to change without notice.



14600 21st Avenue North
Plymouth, MN 55447-3408
www.advance-us.com
Phone: 800-850-5559
Fax: 800-989-6566

240 Superior Boulevard
Mississauga, Ontario, Canada L5T 2L2
www.nilfisk-advance.ca
Phone: 905-564-1149 or 800-668-8400
Fax: 905-564-1030 or 800-263-5111

©2014, Nilfisk-Advance, Inc.,
Printed in U.S.A., Form L3308A, 5-14